

EXISTING CONDITIONS (WITH REMOVALS)

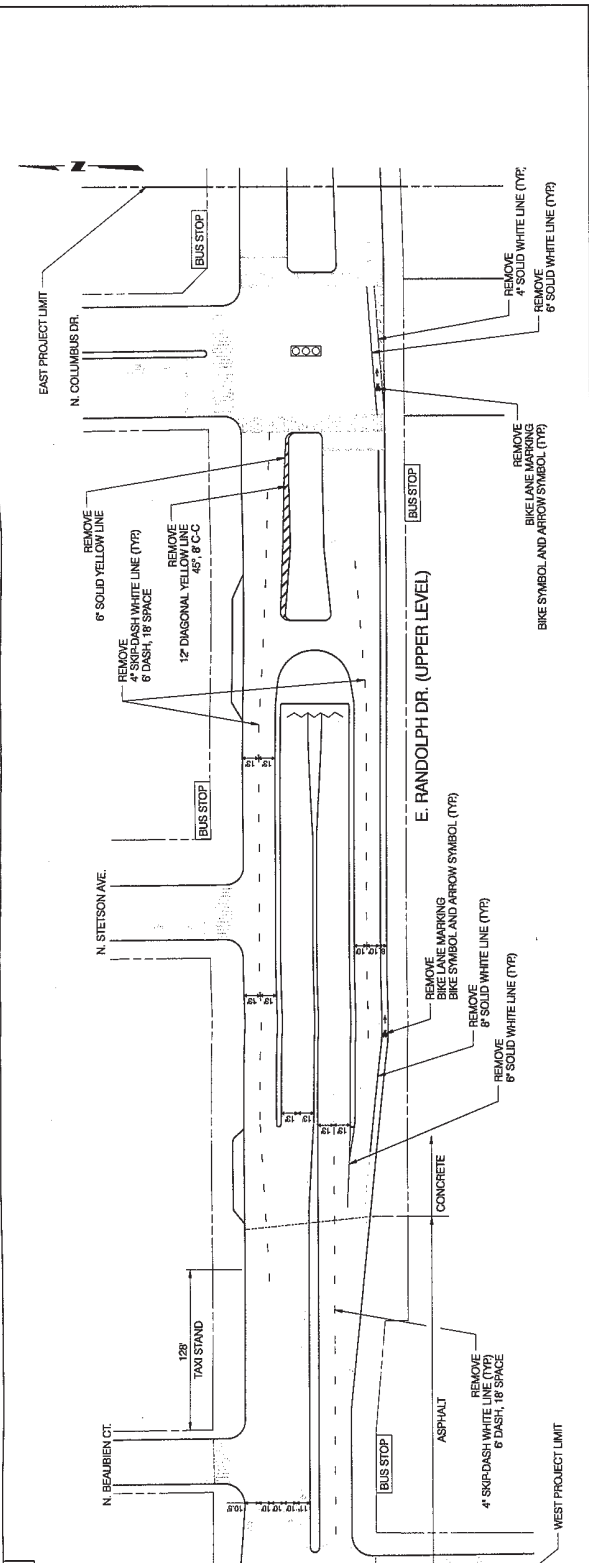

PROPOSED CONDITIONS (WITH INSTALLATIONS)

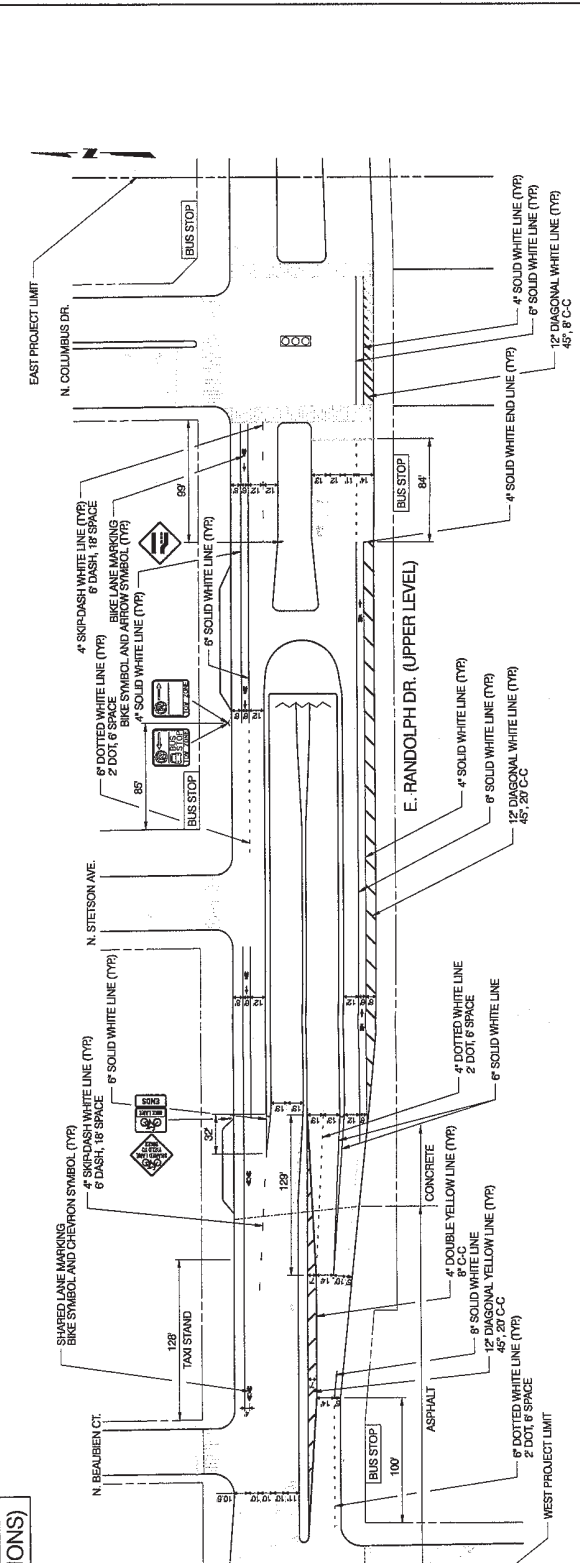

<p>SCALE IN FEET</p>		SHEET NO. 01 DWG. 1 OF 1
DRAWN M.P.V. CHECKED D.B.G. DATE 5.28.10	DESCRIPTION REVISIONS	CITY OF CHICAGO DEPARTMENT OF TRANSPORTATION DIVISION OF PROJECT DEVELOPMENT BICYCLE PROGRAM
42ND WARD INSTALLATION OF BIKEWAY PAVEMENT MARKINGS AND SIGNS STRIPING PLAN		EAST RANDOLPH DRIVE N. MICHIGAN AVE. TO N. COLUMBUS DR.

FIELD BLVD

RANDOLPH LOWER

RANDOLPH ST

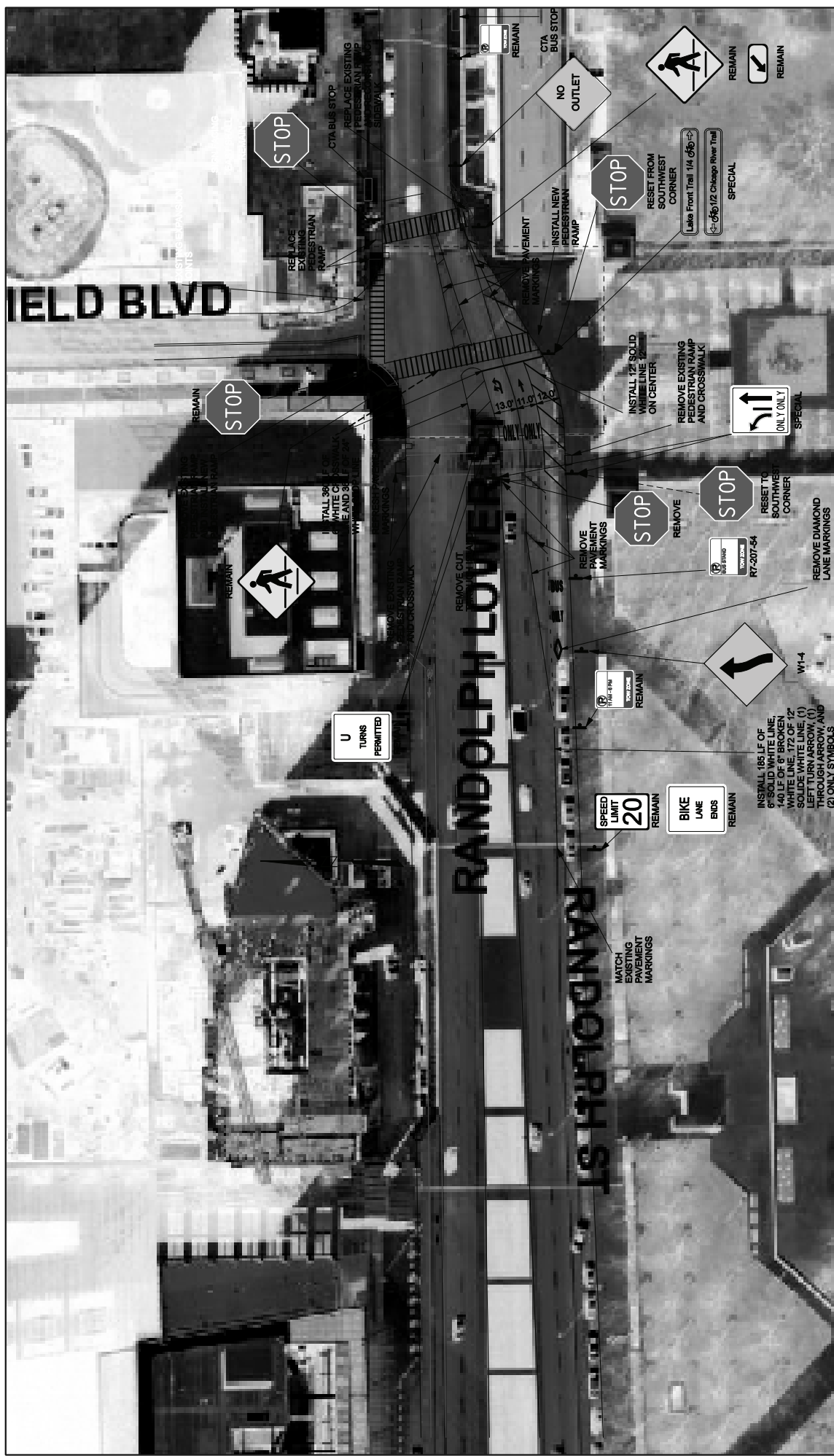

**Randolph Street and Field Boulevard
LONG TERM RECOMMENDATIONS**

CITY OF CHICAGO
DEPARTMENT OF TRANSPORTATION
DIVISION OF PROJECT DEVELOPMENT

SHEET NO. 1 OF 1	DRAWN BY: RCP
SCALE: 1" = 50'	CHECKED BY: RCP
	DATE: 7/22/2010

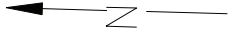

INSTALL W1-1R
BAND TO POLE
(156 N HARBOR)



INSTALL R7-1-4
BAND TO POLE
(156 N HARBOR)



RELOCATE W11-2
INSTALL W16-7p
BAND TO POLE
(150 N HARBOR)

REMOVE STOP BAR MARKING

REMOVE STOP SIGN (R1-1)
(150 N HARBOR)

E. RANDOLPH ST.



INSTALL W1-1L
DRILL IN SIDEWALK
(351 E RANDOLPH)

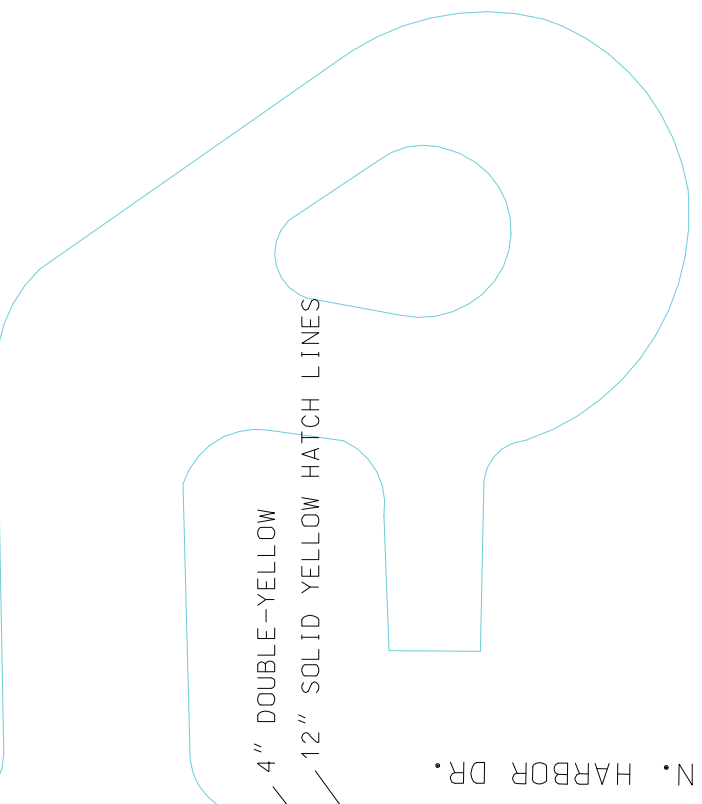

4" DOUBLE-YELLOW

12" SOLID YELLOW HATCH LINES

CTA BUS STOP

N. HARBOR DR.

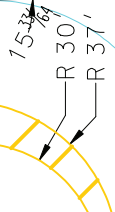

INSTALL W11-2 AND W16-7p
DRILL IN SIDEWALK
ROTATE 15³/₄" FROM CURB LINE
TO FACE EB TRAFFIC
(151 N HARBOR)

INSTALL W1-6R
DRILL IN SIDEWALK
ALIGN WITH SB TRAFFIC LANE
(359 E RANDOLPH)

MEASURED FROM CURVE



GRANT PARK

CHICAGO DEPARTMENT OF TRANSPORTATION

RANDOLPH & HARBOR

DATE:
1/27/09

SCALE:
50:1

42ND WARD

SHEET 1 OF 1